

Dios

---

# DIOS-1288

MASSAGE CHAIR

## MANUAL

---



8D  
MASSAGE  
SYSTEM





# CONTENTS





Please read and follow all safety instructions listed in this user manual before use. Basic precautions should always be considered when operating an electrical appliance.

Safety Instructions	.....	2
Product Components	.....	7
Chair Installation	.....	9
Operation Guide	.....	15
Troubleshooting	.....	24
Maintenance	.....	25
Product Specifications	.....	26



- Please read this manual carefully to make sure the installation and operation of the massage chair is done correctly.
- “Safety Instructions” are provided for important safety information. Both Warning and Caution are important safety precautions, please be more cautious.

	<b>Warning</b>	This sign indicates a warning of causing possible death or injury to the body.
	<b>Caution</b>	This sign indicates caution of causing possible pain or damage to the body.

	This sign indicates forbidden behavior.
	This sign indicates must follow instructions to operate.
	This sign indicates self disassembly is forbidden.
	This sign indicates the correct operation of the cable.

- The following should be kept for any further reference.

# SAFETY INSTRUCTION



## Warning

	<ul style="list-style-type: none"> <li>• Osteoporosis patients ;</li> <li>• People with heart disease including embedded pacemakers or another medical electronic device inside the body ;</li> <li>• For pregnant women or people with health issues, please consult with a doctor before use ;</li> <li>• Patients with a high fever are forbidden to use this machine.</li> <li>• Perceptual disabilities patients are forbidden to use this machine. People over 80 years old are forbidden to use this machine. Kids are not allowed to use the chair ;</li> <li>• Don't operate the chair after the use of alcohol.</li> <li>• Please don't sleep in the chair.</li> <li>• Don't use the chair when your body is wet.</li> </ul>	<p>People who are not suitable to use the chair</p>
	<ul style="list-style-type: none"> <li>• Make sure there are no kids or pets or other objects around (under, behind, or in front of) the chair at the moment of the backrest, leg-rest up/down, or leg-rest retraction/extension from the reclining position.</li> <li>• During the operation, if the body is abnormal, please stop the operation and go consult with your physician.</li> <li>• Please do not take a strong massage on the head.</li> <li>• Do not massage the belly or knees, be careful when massaging the neck.</li> <li>• Children or pets are not allowed to play on the chair, especially during massage. Standing or sitting on the back or armrest is not allowed either.</li> <li>• Those who move around with difficulty or can't express themselves must be taken care of strictly and continuously during massage.</li> </ul>	<p>Accident /injury</p>
	<ul style="list-style-type: none"> <li>• Insert the plug of the chair into a correct and suitable power socket.</li> <li>• Make sure the plug is completely inserted into the socket to reduce short circuit or fire risk.</li> <li>• Unplug the power when not in use, stop all massage functions, and turn off the on/off key before unplugging.</li> </ul>	<p>Fire and electric shock</p>
	<ul style="list-style-type: none"> <li>• Massage cushions of the chair are not allowed to be folded for storage.</li> <li>• The machine is forbidden for no-load running for a long time.</li> </ul>	<p>Accident</p>
	<ul style="list-style-type: none"> <li>• The power cord, plug, and socket can't be used in broken or loose contact conditions.</li> <li>• Don't use other electric power except for rated voltage in case of fire, electric shock, or any breakdown.</li> <li>• Any broken, re-processed, knotted, or twisted power cord or pressed under heavy cargo is not allowed to be used.</li> </ul>	<p>Fire and electric shock</p>



## Warning



- If the chair is dysfunctional or broken, splashed with water, or falls into water, please have it repaired by a professional repairman or send the chair to an assigned service agent. Self-modification, disassembly, or maintenance is forbidden.
- If the power cord or plug is damaged, please don't replace it yourself, please contact us or an appointed dealer for replacement.
- To avoid electric shock or body injury, please don't open or disassemble any part of the chair, there is not any attached part of the chair for maintenance by customers.
- Check if leather or cloth material on the back and other areas are broken or not. If broken, even if small, please stop using the chair, unplug the power, and have it repaired.

Disassembly and maintenance



## Caution



- Please operate the chair when it is flat or in a leveled place.
- Position the chair 4 inches from the wall to allow for sufficient space to recline up and down.
- The maximum suggested operating time is 20 minutes. 5 mins for each position beginning with the slight- step massage. A continuous massage in the same position may cause uncomfortable feelings.
- Before sitting on the chair to avoid injury. Please inspect everything to confirm that the massage heads are in the correct position.
- Please make sure that the power switch is on "OFF" position before inserting the plug into the socket.
- Turn off all controls before removing the plug from the outlet.
- Make sure the plug is completely inserted into the socket.
- Check whether there are any damages on the wire and make sure there is no water or rubbish on the wire.
- Correctly installing the wire. The plug must be inserted into the socket with the connect, the connect couldn't be bent or cut off.



To avoid sudden falling.

To make sure the back lying.

Too long time massage is bad for your body.

To avoid accidental injury.

To avoid the accident when turn on the power.

To reduce short circuits and any fire hazard.

To avoid electric shock in any leakage or breakdown.







- Don't use or store the chair in a wet environment like near the swimming pool, or bathroom.
- Keep the chair and remote control dry at all times.
- Don't use the chair when your body is wet.

To avoid leakage or electric shock.

# SAFETY INSTRUCTION

## Caution

	<ul style="list-style-type: none"> <li>• Don't press with your hands or step on the massage heads with your feet.</li> <li>• Don't put your hands between the working massage heads.</li> <li>• Don't put your hands or feet in the gap between mechanical parts.</li> <li>• Don't drop or insert anything into the slot of the massage chair.</li> <li>• Don't stand or sit or put anything on the backrest, armrest, or legrest.</li> <li>• Don't stand on the chair during the operation. Don't move the chair during the operation.</li> <li>• Don't pull out the plug or turn off the power during operation.</li> <li>• Don't put your hands or head between leg-rest or beneath.</li> <li>• Don't use the massage chair while wearing hair ornaments.</li> <li>• Don't put hard things in your pocket when taking buttocks and huckle massage.</li> <li>• Don't sit or press on the backrest when the chair is in a reclining position. Don't use it on bare skin or wearing thin clothes, thin clothes may cause a better massage effect, But it also may cause irritation to the skin or cryogenic burns.</li> </ul>	<p>To avoid accidents or injury</p>
	<ul style="list-style-type: none"> <li>• Keep the chair away from heat, wet, sharp things and corrosive, inflammable, explosive environment.</li> <li>• Using an electric blanket or other heating products on the chair is forbidden.</li> <li>• Don't put in the space of a serious or corrosive gas environment.</li> <li>• Don't put the chair in small space places or use it in bad air circulation places.</li> </ul>	<p>To avoid fade, discolor on upholstery or hardened, deteriorated on PU.</p>
	<ul style="list-style-type: none"> <li>• Keep the chair away from the stove or other heating products.</li> <li>• Don't put the chair directly under the sun or other high temperature places.</li> <li>• Don't use the chair outdoors.</li> </ul>	<p>To avoid electric shock.</p>
	<ul style="list-style-type: none"> <li>• Make sure to install the wire in the correct way(In-correct installation may cause electric shock. If you don't know how to install, please find a professional electrician)</li> <li>• Don't use a plug adapter (If the enclosed plug doesn't match with socket, please don't change the plug by yourself and find a professional electrician to install a matched socket.)</li> </ul>	<p>To avoid electric shock.</p>

## Caution

	<ul style="list-style-type: none"> <li>• Unplug the power before cleaning the chair.</li> <li>• Unplug the power after using the chair.</li> </ul>	To avoid electric shock or fire hazards.
	<ul style="list-style-type: none"> <li>• Unplug the power when there is any damage on the power.</li> </ul>	
	<ul style="list-style-type: none"> <li>• Hold the plug to unplug the power but do not try to pull the wire to unplug the power.</li> </ul>	
	<ul style="list-style-type: none"> <li>• Please turn off the power switch and unplug the power after massage.</li> </ul>	To avoid accidents
	<ul style="list-style-type: none"> <li>• Unplug the power immediately when electricity goes off.</li> </ul>	To avoid damage or accidents when power on again.



- Warning :**
1. Do not use it when gets wet.
  2. Supervise the disabled people.
  3. The chair has heating function, people who are insensitive to heat must pay high attention.

## | Grounding instruction |

The chair is equipped with a cord having a grounding conductor. The plug must be plugged into an appropriate socket that is properly installed and matched with the plug.

 <p>The earth wire is not allowed to be in these places</p>	<p>Gas pipe: probability of causing explosions or fire.</p> <p>Phone wire and lightning rod: cause electric shock and fire when thundering.</p> <p>Water pipe: earth wire is useless where there are plastics</p>
--	---

# PRODUCT COMPONENTS

## | Main body diagram (front) |

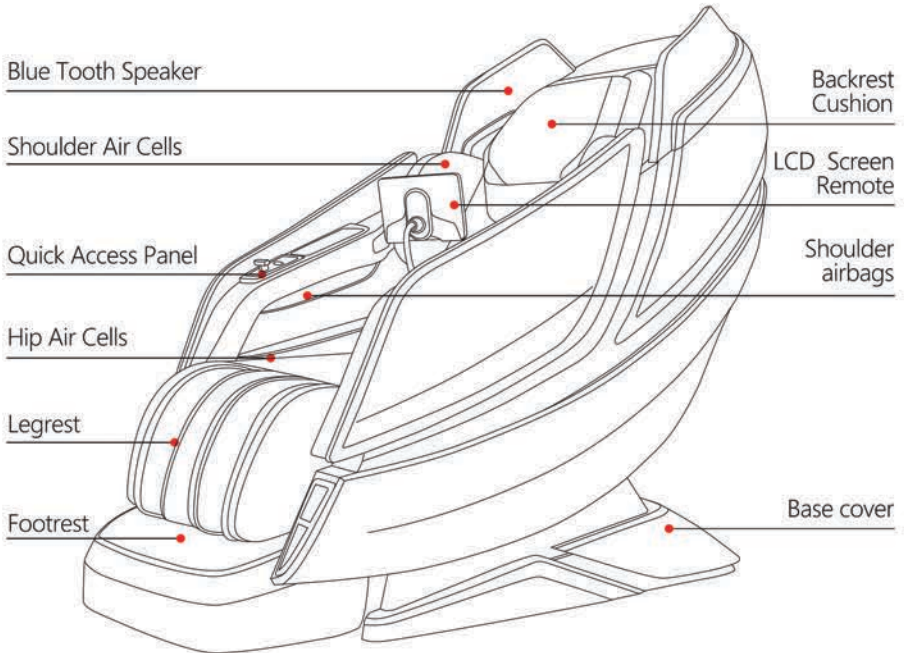

Built in Premium Bluetooth Speakers





## | Main body diagram (rear) |

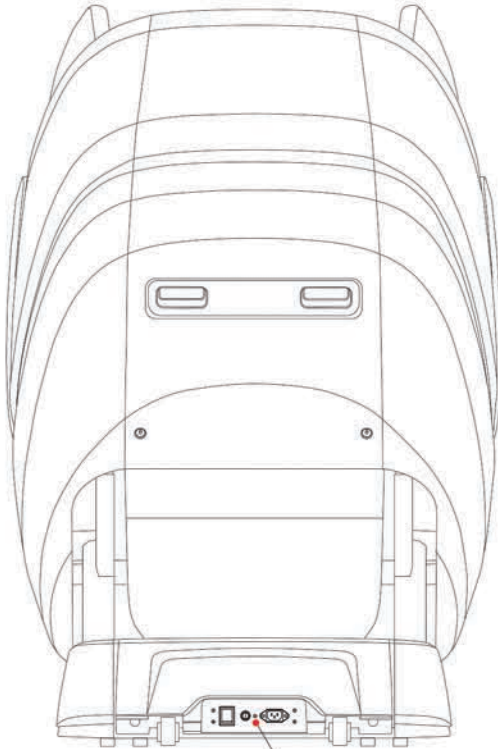

(The Reserve Side)



Power Switch    Safety Fuse    Power Cord Socket

# CHAIR INSTALLATION

1. Remove the package and take out the chair parts and components |



Remove the carton.

Take out the packing material. Put the plug into the electrical socket, then turn on the massage chair, and let it reset to its original position.

\* The spare parts include: the remote control, holder, user manual wheel, and power cord.

**Note: Unplug the power after reset.**

## Components |

1. A screwdriver and Allen-wrench is needed to complete the installation.
2. Allen wrenches are included in the parts bag, but you will need a screwdriver as well.

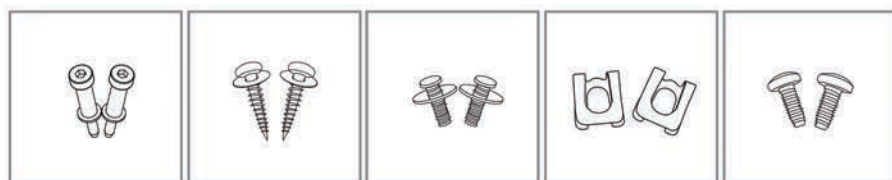

Screws

Screws

Screws

Gasket

Screws

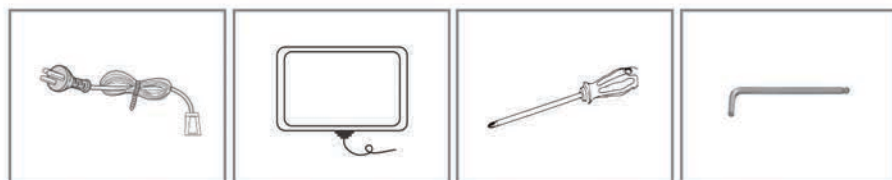

Power plug

LCD controller

Bolt driver

Inner hexagon spanner

## 2. Installation side panels

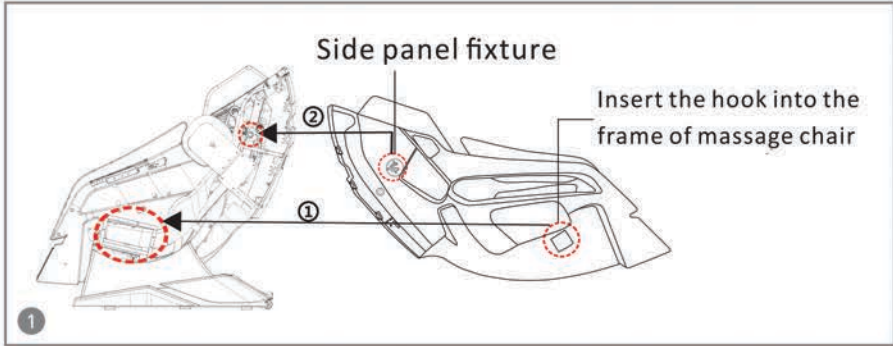

1. According to ① ② in Figure 1, first hang the hook on the side panel to the lower iron frame of the main iron frame, and then push forward to clamp the side panel fixing into the main body.

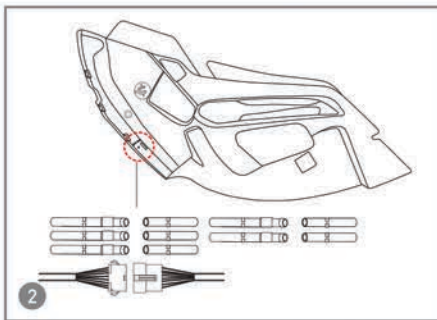

2. Connect the plug wires and air pipes of the same color as shown in Figure 2. (5 air pipes and 1 plug wire on the left side panel; 4 air pipes and 1 plug wire on the right side panel)

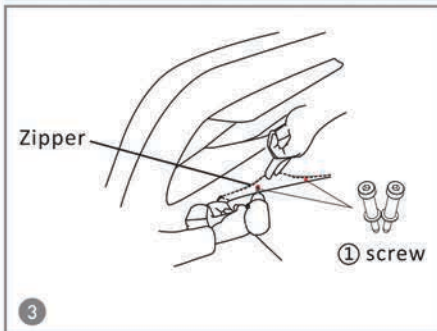

3. Unzip the zipper of the side panel and find two screw holes, and tighten screws the screw holes, refer to ③

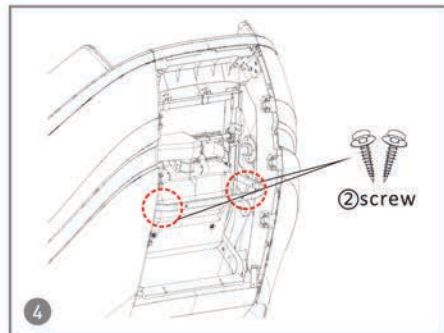

4. The right side panel installation method is the same as the left side panel except that the right side panel has two less air pipes and a separate air pipe connector

5. After fixing both left and right side panels, tighten all screws in a pointed position, refer to ④

# CHAIR INSTALLATION

## 3. Install the decorated plastic bar onto the head cover |

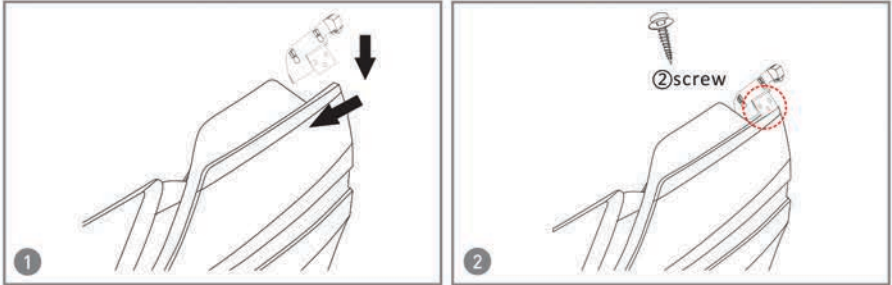

1. Install the decoration plastic bar onto the head cover.
2. Put the head cover on the appointed position, push forward, refer to the diagram 1, and then put the decorated plastic bar on the side panel fixture position.
3. Tighten 2 screws on both side panels' position.

## 4. Install the back cover |



1. Put the back cover onto the massage chair, then lightly tap the back cover to let the buckles match each other
2. Tighten 3 screws into the pointed positions, refer to 3

## 5. Installation of legrest unit |

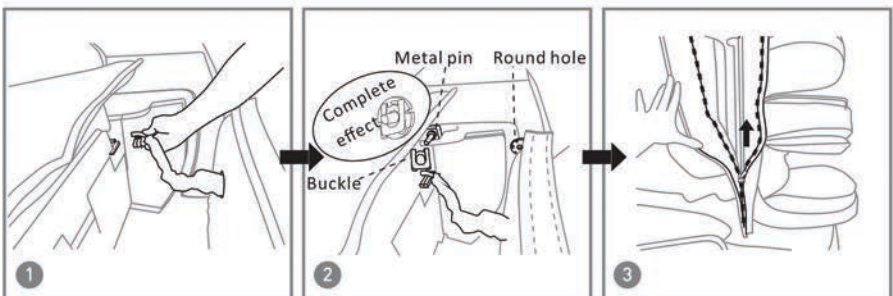

1. First connect the trachea of the leg with the bus on the massage chair.
2. Lift the leg and insert the round hole in the upper right corner of the leg into the metal pin shaft of the massage chair, and then insert it with a buckle to fix it.
3. When installing the left side, first move the whole leg to the right, align the round hole in the upper left corner and the pin of the massage chair, move the lower leg to the left, and then insert the buckle to fix it.
4. Pull the holster on the leg to the zipper of the massage chair.
5. Finish the leather case.

## 6. Installation of legrest unit

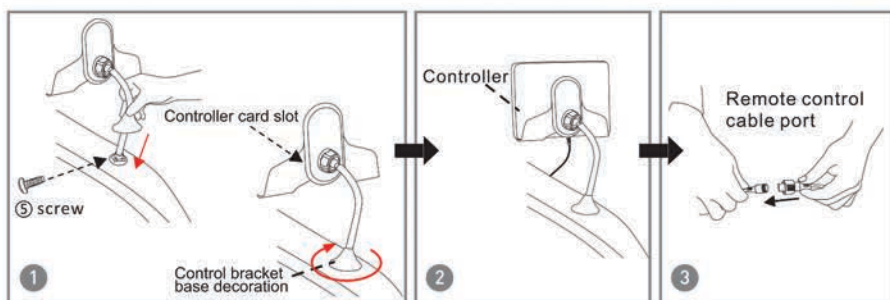

1. Align the holes of the hand control bracket with the mounting holes of the bracket base on the armrest, then lock the No.5 screw into the hole to fix the bracket, and finally push the hand control bracket base decoration down to the bracket base, and finally turn the buckle clockwise to secure.
2. When the pad controller is clicked into the controller bracket, a "click" sound is heard before it is completely fixed.
3. Then, dock the pad controller cable with the connector on the massage chair.

## 7. Install backrest

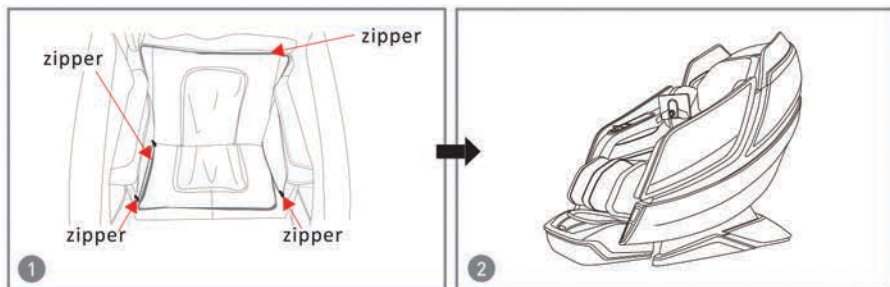

1. Close the zippers on the left and right seats and the backrest of the massage chair; close the zipper on the cape and the main body of the massage chair.
2. The installation is done.

## CHAIR INSTALLATION

### | 8. Before use |

Use the controller to place the backrest frame to the extreme position, raise the calf to the highest position and raise it to the longest position. Make sure there is sufficient space around the massage chair before the operation.

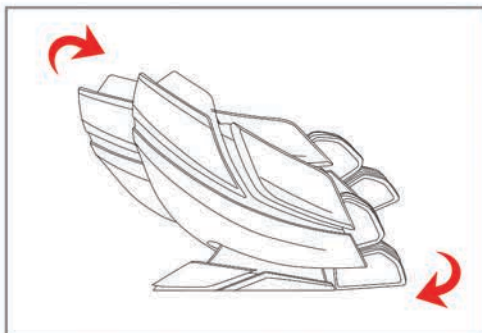

Use the controller to place the backrest frame to the extreme position, raise the calf to the highest position and raise it to the longest position. Make sure there is sufficient space around the massage chair before the operation.

### | 9. Moving the massage chair |

After completing the installation, put the chair in an incline / upright position to move the chair easily.

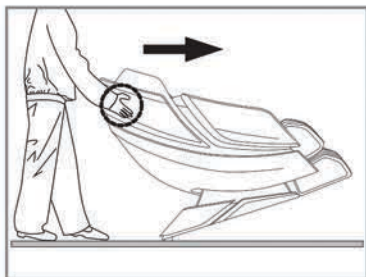

- As illustrated, tilt the chair back onto its wheels at 45° angle. Slowly push and maneuver the massage chair to the desired location. Lower the massage chair slowly and smoothly until it is fully flat on the ground.

### CAUTION

- \* Do not move the massage chair when occupied or in use.
- \* Moving the massage chair may cause damage to the floors. Floor protection is recommended (e.g. rugs or carpets).
- \* Do not drop or suddenly let go of the chair when moving as it may damage the chair.
- \* Two persons are recommended when moving and extra care when handling the massage chair.
- \* Make sure the power plug & remote is disconnected to prevent damage. The warranty will not cover the power cord & remote if the chair is moved with the plugs connected.

### 10. Place the massage chair in an open area |

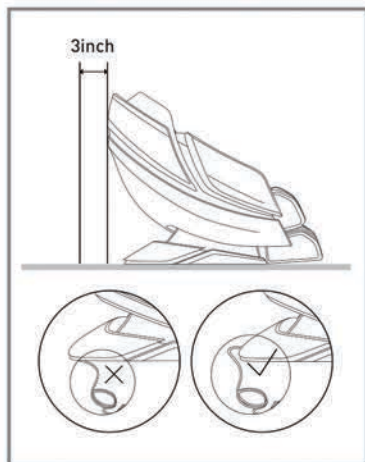

- Allow sufficient space around the chair for recline purposes.
- 3 inch distance for the back side and 19.7 inches in front of the footrest.
- \* Do not put the power cord under the relaxed chair!



## | Quick Control |

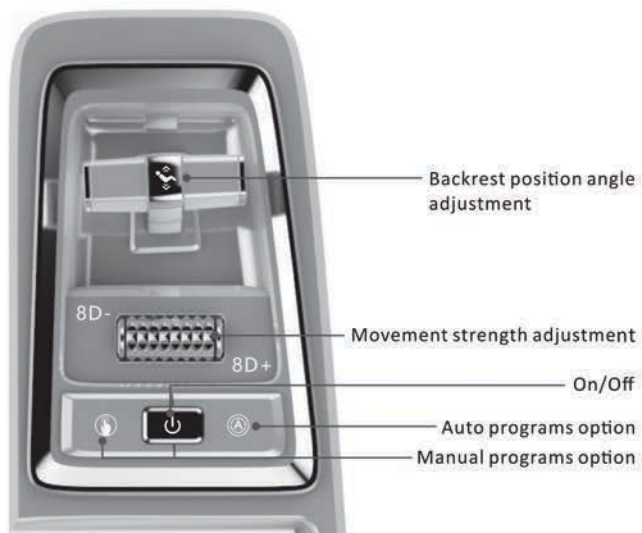

## | Remote Controller |

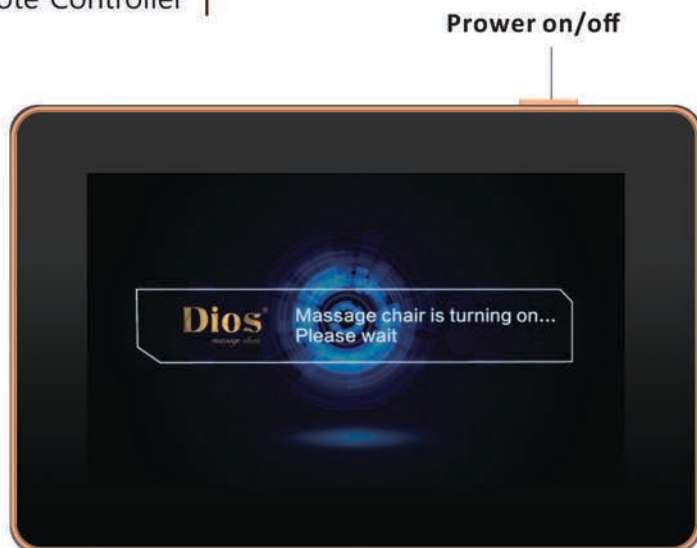



## 1.Remote controller interface and description

- Open the remote controller and the main menu will be displayed. Please select the program you want.

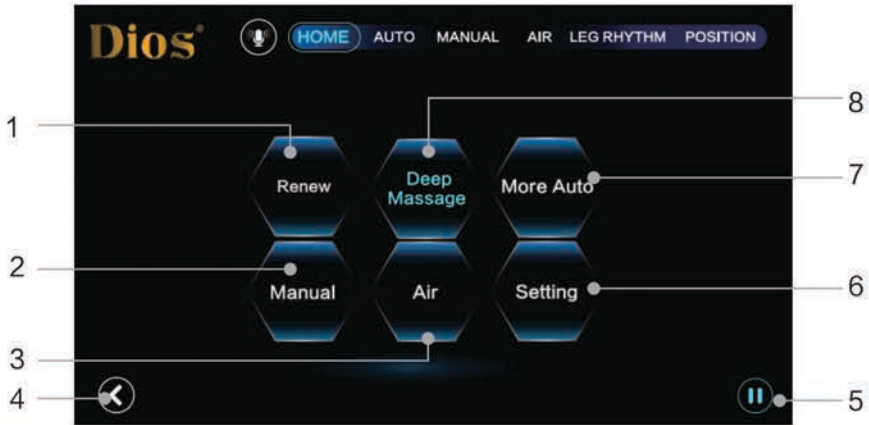

- 1.Renew    2.Manual modes    3.Airbag massage    4.Return  
 5.Pause    6.Settings    7.More automatic modes    8.Deep massage

## 2.Settings



- 1.Sound adjustment area    2.Return    3.Language selection  
 4.Pause    5.Light strip switch

# OPERATION GUIDE

## 3.Auto modes

- There are 24 kinds of all-round unique automatic massage modes in the corresponding massage area.

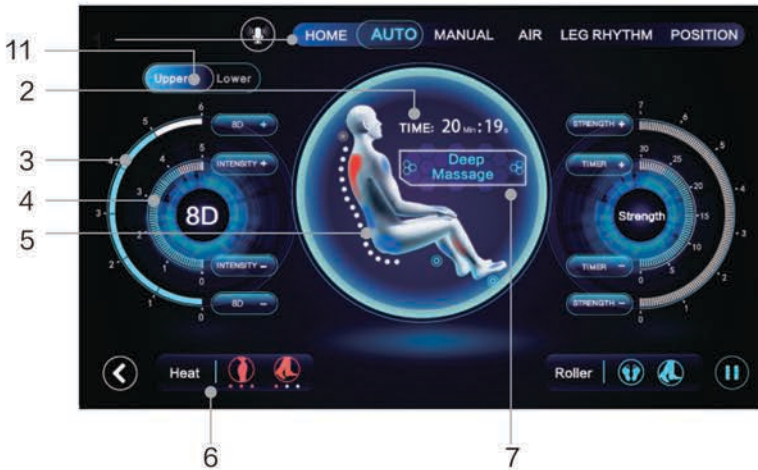

- 1.Voice control
- 2.Display the remaining massage time
- 3.8D massage intensity adjustment area(only upper body control)
- 4.Airbag intensity adjustment zone
- 5.Movement / airbag / heating / roller massage area display
- 6.Heating site selection
- 7.Automatic program name display
- 8.Sole roller location selection
- 9.Movement speed/strength adjustment
- 10.Massage time adjustment
- 11.Manual massage of the upper or lower body

Statement :Dual movement operation rules follow the lower movement to avoid the upper movement operation when the distance between the two movements triggers anti-collision safety logic, the lower movement will give priority to traveling down to avoid a crash with the upper movement, so it will be a little different from the set mode of operation, it is a normal phenomenon.

## 4. Detection



1. Press any of the automatic modes and the latest smart body detection will be turned on (only automatically detected once after booting).
2. After the inspection is completed, within 8 seconds, the user can choose to fine-tune the shoulder position according to his needs. You can also press OK directly to confirm the shoulder position.

## 5. Manual Modes

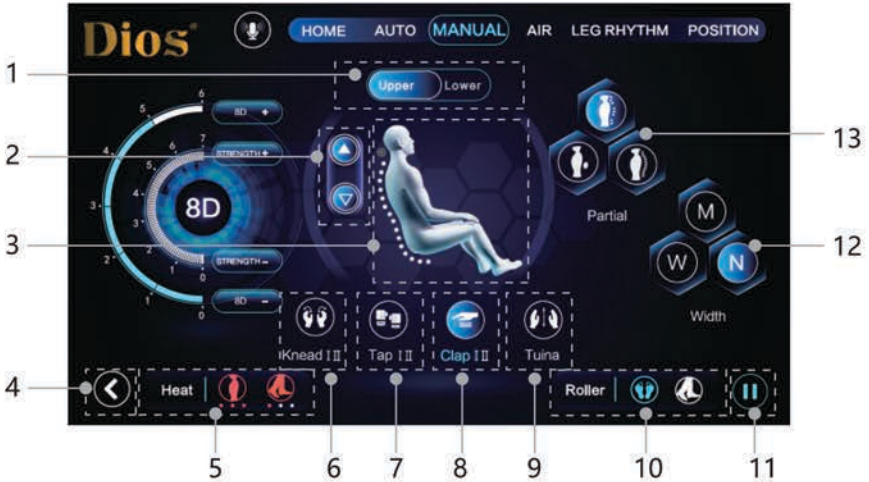

1. Manual massage of the upper or lower body
2. Adjustment of the up and down position of the massage movement
3. Massage movement area display
4. Return
5. Heating site selection
6. Kneading massage (2 levels adjustable)
7. Tapping massage (2 levels adjustable)
8. Clapping massage (2 levels adjustable)
9. Tuina massage
10. Selection area of sole roller part, leg rubbing on /off
11. Pause
12. Massage width adjustment area (not effective when kneading is on)
13. Massage interval adjustment area

## 6. Airbags massage



- 1. Airbag massage intensity adjustment area
- 2. Airbag massage area display
- 3. Airbag massage area selection area
- 4. Return
- 5. Heating area selection area
- 6. Selection area of sole roller part
- 7. Pause

## 7. Leg vibration



- 1. Return
- 2. Slow speed vibration
- 3. Gentle speed vibration
- 4. Quick speed vibration
- 5. Pause

## 8. Sitting adjustment



1. Backrest down and up
2. Footrest extension
3. Footrest raised and lowered
4. Zero-gravity position area: three levels option

## 9. Voice control

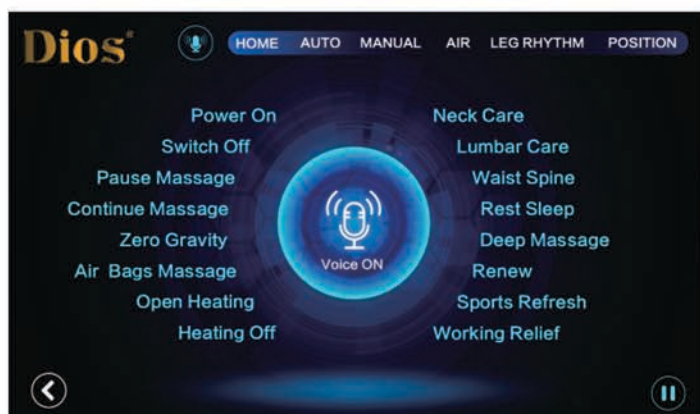

Please first press this icon before using verbal control:



Touch to jump to the voice assistant interface, when the power is turned off in the electrical control box position. The voice on can not wake up the massage chair.

### 10. Pairing massage chair with Bluetooth music

a. Pairing :turn on Bluetooth device in the cell phone or iPad.  
Search for DIOS-1288.

b. Playing music :after pairing use the control device in the cell phone or iPad to manage.

Note :Disconnect Bluetooth when the massage chair is not in use



## | 3 After use |

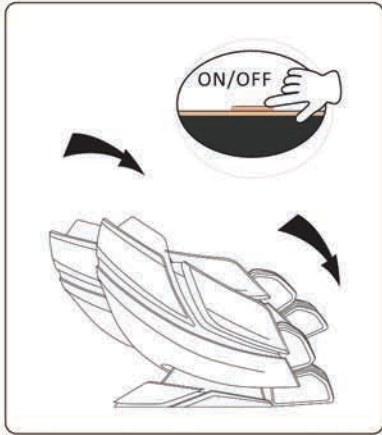

1. After the massage program is completed return the massage chair to an upright position by turning off the massage chair.

Please check the surroundings prior to adjusting the recline angle, paying special attention to children or pets that may be in close proximity.

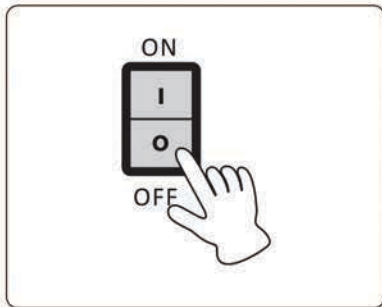

2. Press the power button to power off the massage chair and return the remote controller to the storage area in the arm pocket.

3. Turn off the main power switch when you are not using the chair for a long period. Remove Plug from the power outlet to avoid accidents by kids and pets.

4. Do not operate with wet hands.



## TROUBLE SHOOTING

If the sounds or movements are not normal, please turn off the massage chair and remove the plug from the electric outlet. Please contact the customer service department for further assistance.

855.646.9500 / 1.714.823.3338, [service@kahunachair.com](mailto:service@kahunachair.com)

Problem	Solution
The massage chair is connected to power but is not functioning.	Check to see if the power plug is inserted or if the power outlet is functioning properly.
The remote controller is responding, but the massage chair is not functioning.	The massage chair may have automatically shut down due to overheating protection devices. Please turn off the power and allow the chair to cool off for 30 to 50 minutes.
Both the remote controller and massage chair are not responding.	The massage chair automatically turns into "full stop" mode when a massage program is completed. Please press the power button again to turn off the chair.



KAHUNA CHAIR PRODUCT WARRANTY REGISTRATION  
[WWW.SERVICE.KAHUNACHAIR.COM](http://WWW.SERVICE.KAHUNACHAIR.COM)

# MAINTENANCE

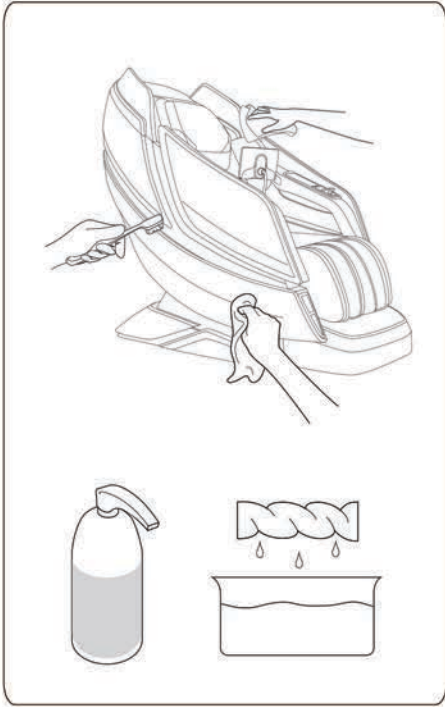

| Use a dry cloth to clean |

Turn off and pull out the plug before cleaning the massage chair, do not touch the plug with wet hands.



Prohibit using liquid cleaning products like water, alcohol, or other cleaning products to maintain a good quality.

## PRODUCT SPECIFICATIONS

Description	Specifications
Product Name	Dios Massage Chair
Model No.	Dios-1288
Rated Voltage	110V~
Rated Frequency	50/60Hz
Rated Power Consumption	180 W
Dimension (LxWxH) Inches	63.4 x 35 x 51.8 inches
Weight (LBS)	Net Weight : 265.7 lbs Gross Weight : 332.9 lbs



**Product** Massage Chair

**Model** DIOS-1288

Developed by RJ Distribution INC

15111 S. FIGUEROA ST

GARDENA, CA 90248

**Tel** 1-855-646-9500

**Email** INFO@KAHUNACHAIR.COM

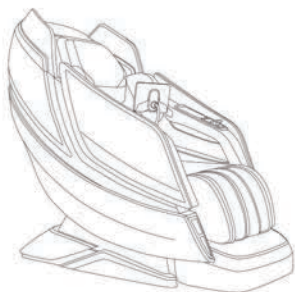

You must register warranty at [www.service.kahunachair.com](http://www.service.kahunachair.com)

INSTRUCTION MANUAL  
MODEL:DIOS-1288

Please read this user manual thoroughly prior to operating the massage chair. Store this booklet for future reference.